



PARAMOUNT
REALTY

FORMER CVS/PHARMACY

165 SOUTH RICHLAND AVENUE, YORK, PA 17404

York County | GLA: ± 10,158 SF



- 10,158 SF CVS/Pharmacy located at the intersection of West Princess Street & South Richland Avenue with combined traffic counts exceeding 19,900 vehicles per day
- Situated near dense residential community, schools and businesses

DEMOGRAPHICS	1 Mile	3 Mile	5 Mile
Population:	22,618	81,164	147,675
Avg. HH Income:	\$85,781	\$83,939	\$76,771
Households:	4,619	22,595	57,010

ARLENE GRAY agray@paramountrealty.com
KRISTI PENNINGTON kpennington@paramountrealty.com

120 North Pointe Blvd., Suite 301, Lancaster, PA 17601
717-569-9373 | paramountrealty.com

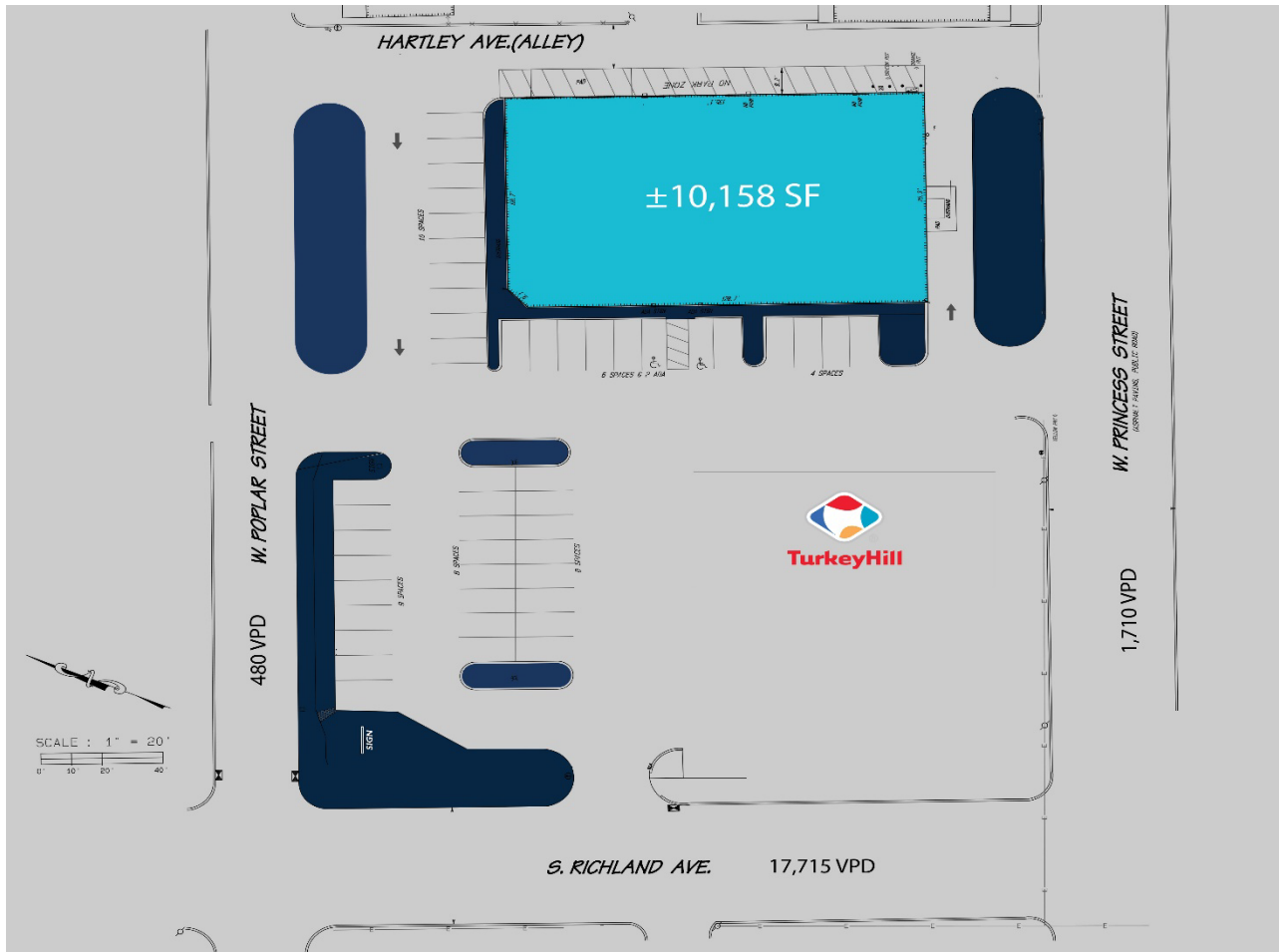

FORMER CVS/PHARMACY
100% LEASED

Subject To Change

1 AVAILABLE 10,158 SF



The information herein (including all faxes pertaining to the same) has been obtained from sources deemed reliable. While we do not doubt its accuracy, we have not verified and make no guarantee, warranty, or representation about it. It is your responsibility to independently confirm its accuracy and completeness and is subject to correction or can be withdrawn without notice.



ARLENE GRAY agray@paramountrealty.com
 KRISTI PENNINGTON kpennington@paramountrealty.com

120 North Pointe Blvd., Suite 301, Lancaster, PA 17601
 717-569-9373 | paramountrealty.com



PARAMOUNT REALTY

FORMER CVS/PHARMACY

165 SOUTH RICHLAND AVENUE, YORK, PA 17404

